

# Ultra Pro Hover HD 250 Amplified Antenna Bar User's Manual



**YOU MUST PERFORM A  
CHANNEL SCAN AFTER  
INSTALLATION.**



**PLEASE REFER TO YOUR TV MANUAL FOR SCAN  
INSTRUCTIONS OR CALL TV MANUFACTURER.**



**PLEASE DO NOT  
RETURN TO STORE**

Questions? Contact us at 1-800-654-8483 between 7:00AM—8:00PM CST.

**Introduction:** The 37075 Ultra Pro Hover HD 250 Amplified Antenna Bar is specifically designed to receive digital TV reception. The sleek and stylish design will blend in with any décor and fit most HD televisions.

**Important safety instructions:**

- **USE** only indoors.
- **DO NOT** install in wet locations or locations that can get wet.

**Features:**

- VHF/UHF/HDTV
- TV/wall/table mountable
- Stylish slim profile
- Low noise amplifier

**Package Contents:**

- Digital Indoor Antenna with TV mount
- Wall mounting hardware
- UL-listed power adapter
- Low noise amplifier
- User's manual

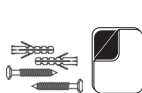
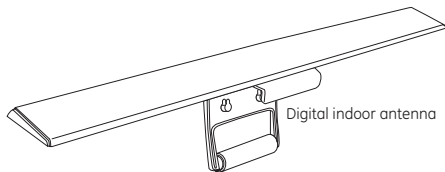

Wall mounting hardware

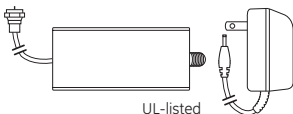

UL-listed power adapter

### Antenna Assembly & Installation:

1. After removing Antenna from package, select the mounting method you prefer and place the antenna in the desired location.
  - a. Mount above TV or to wall.
  - b. Lay the antenna flat.
  - c. Use the TV mount (as shown below).

**Note:** When mounting to your HD television, in order to get the antenna to fit properly, please adjust the television mounting bracket by opening it enough so that the antenna sits flush on the television. When moving the bracket you should hear a click when opening or closing the mount to know that it is working.

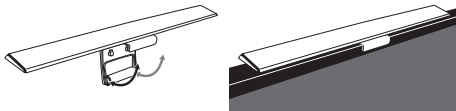

**Note** If you want to lay the antenna flat on a surface you can remove the antenna stand with a Philips head screwdriver.

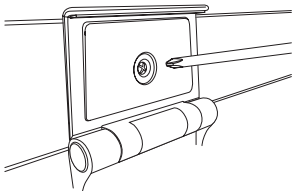

2. Connect the coax cable from the antenna to the **low noise amplifier**.
3. Connect the **low noise amplifier** into the TV.

4. Connect the UL-listed power adapter and plug into an available wall outlet. **Note: UL listed power adapter needs to be plugged in for the antenna to work properly.**
  - a. If desired use the supplied adhesive strips to mount the amplifier to the back of your TV.
5. **SCAN FOR CHANNELS ON YOUR TV:** This step is very important. Your TV will NOT receive signals from the antenna without doing a channel scan. See your TV's menu for this process. You can also refer to the TV instruction manual for detailed instructions.

**Note: If you have poor TV reception after scanning for channels, go back to Step 2 and remove the low noise amplifier and connect the antenna directly into the TV. Remember to re-scan for channels if you do this.**

**Note: It is important to repeat this process and re-scan for channels anytime you move the antenna, re-position the antenna.**

6. Contact us at 1-800-654-8483 if you need assistance.

### **Antenna helpful tips**

**Maximize** the number of channels you receive by placing the antenna in several different locations to see which location provides the best reception and the maximum number of channels. Be sure to run a new channel scan on your TV in each position. Refer to the instruction manual that came with your TV if you are not sure how to do this.

**Position** or mount the antenna as high as possible or near a window for best performance.

**Visit** [www.antennaweb.org](http://www.antennaweb.org) or [www.dtv.gov](http://www.dtv.gov) and look for the DTV Reception Maps to determine the available television stations and location of the broadcast towers in your area.

MADE IN CHINA

GE is a trademark of General Electric Company and is under license by Jasco Products Company LLC, 10 E. Memorial Rd., Oklahoma City, OK 73114.

This Jasco product comes with a limited-lifetime warranty. Visit [www.byjasco.com](http://www.byjasco.com) for warranty details.

Questions? Contact us at 1-800-654-8483 between 7:00AM—8:00PM CST.



THIS PACKAGE IS  
RECYCLABLE

37075

V2

9-6-2017